

Neighborhood Congregational Church Affordable Housing & Spiritual Center Development

Application Plans | March 2025

ktgy

RELATED

City of Laguna Beach Goals/Housing Element

Collaboration



The City of Laguna Beach Housing Element identified Neighborhood Congregational Church’s property as one of the 4 sites to potentially yield new affordable housing. The location of the site and the willingness of the site’s owner make it viable to pursue at this time.

State of CA Mandate



The City of Laguna Beach must plan for and accommodate the development of 394 housing units over the next 5 years. 198 units are needed for extremely low, very low and low-income households.

Income Eligibility & Rents



Target household income levels will be from \$33,000 to \$117,000 per year. Rents will range from \$800 to \$2,500. Our proposed development will help satisfy the City’s low-income mandates.

Connectivity/Green Space



New neighborhood community spaces for residents and the public.

Proposed Development

RESIDENTIAL

- 44 residential units – 100% affordable
- 2-story buildings
- 1 parking space per unit + on-site management (47 parking spaces)

CHURCH BUILDINGS

- Spiritual center, common use, administration and circulation: Approx. 7,000 SF
- 41 parking spaces for the public and church

Community Benefits

- Rentals with long term affordability with priority for a variety of Laguna Beach workers (e.g., school and city employees, hotel and retail workers)
- Community gathering space for weddings, meditation, cultural events and more
- Glenneyre beautification with expanded sidewalk
- Enhanced landscaping and garden spaces
- Sustainability: reduced greenhouse gas emissions from shorter commutes and solar energy generation
- 41 parking spaces for the public and church



Neighborhood Congregational Church, Laguna Beach



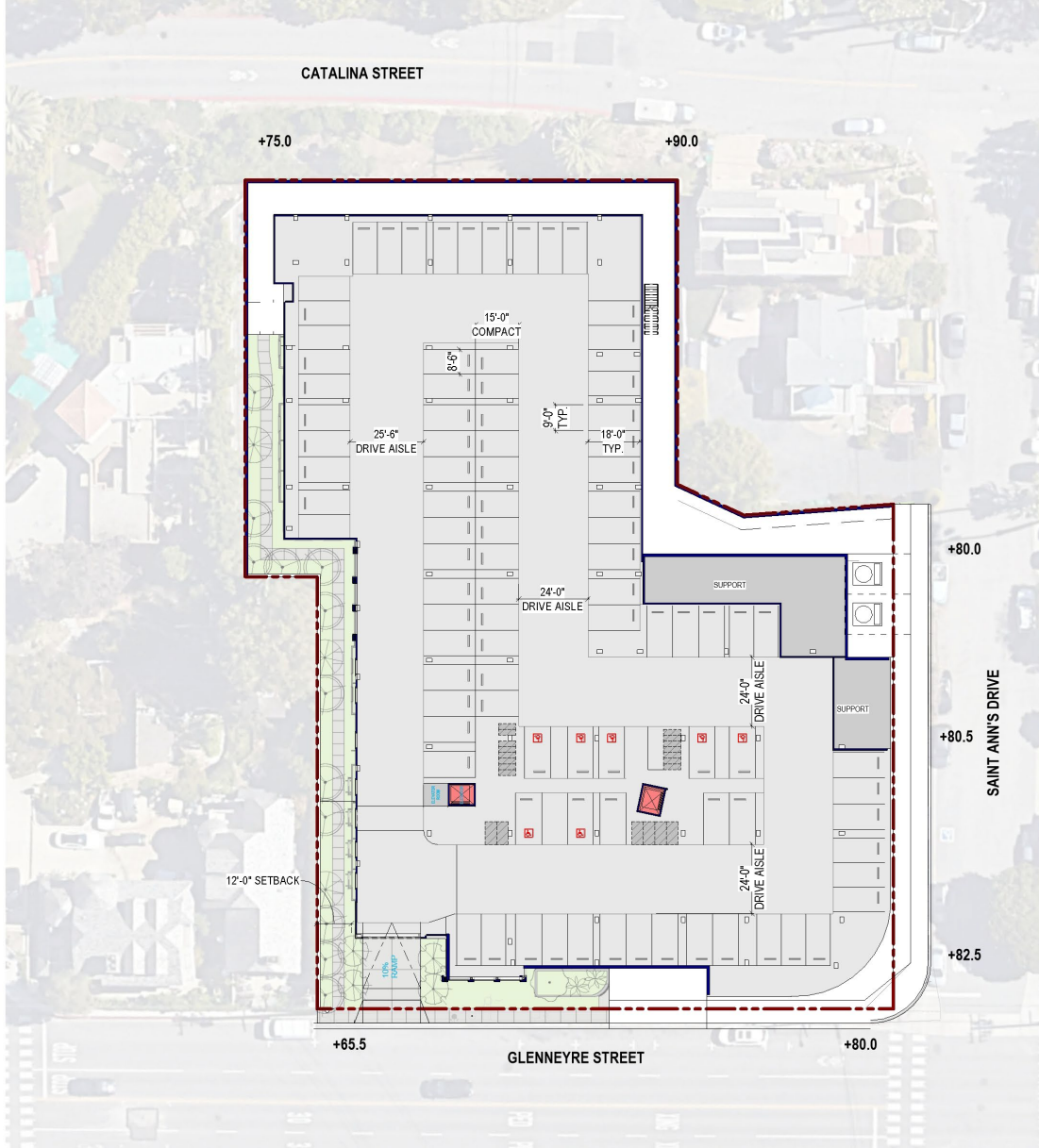

Parking Level



Plaza Level



View from Glenneyre Street

Neighborhood Congregational Church, Laguna Beach

ktgy

RELATED

Thank You.